

# SBM600ix3

U100 / U100w

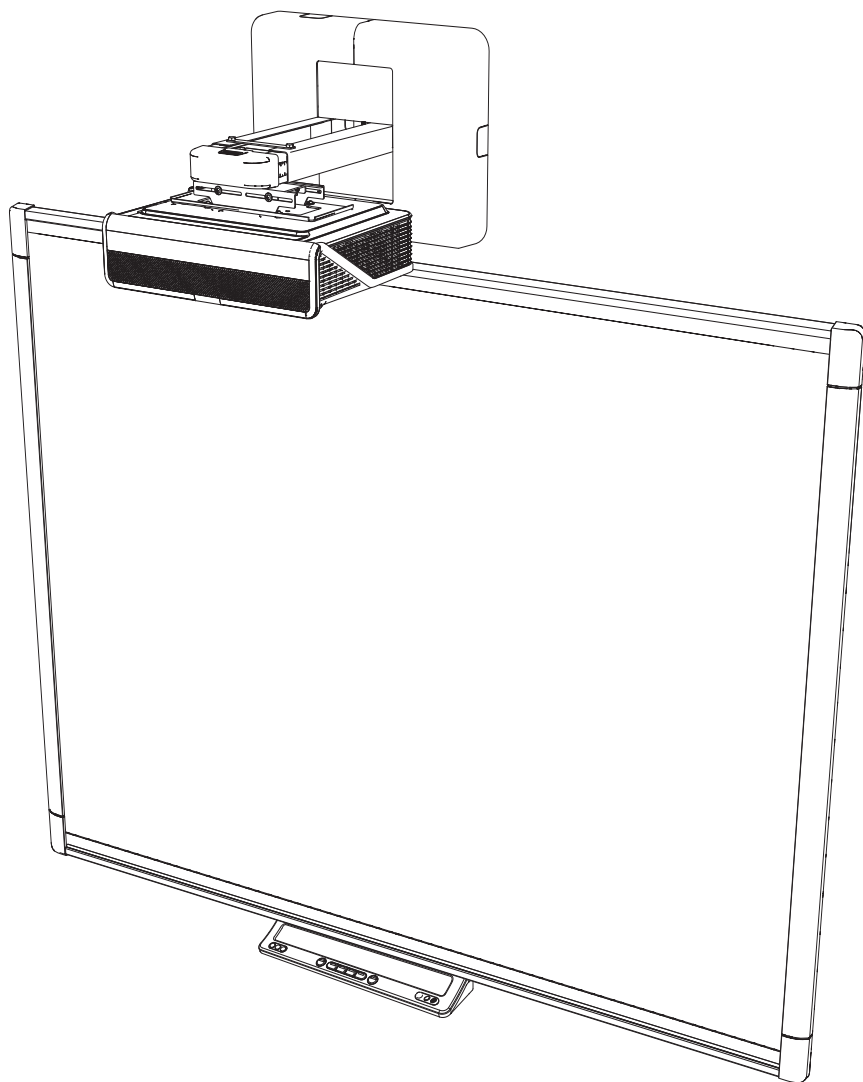

**SMART®**





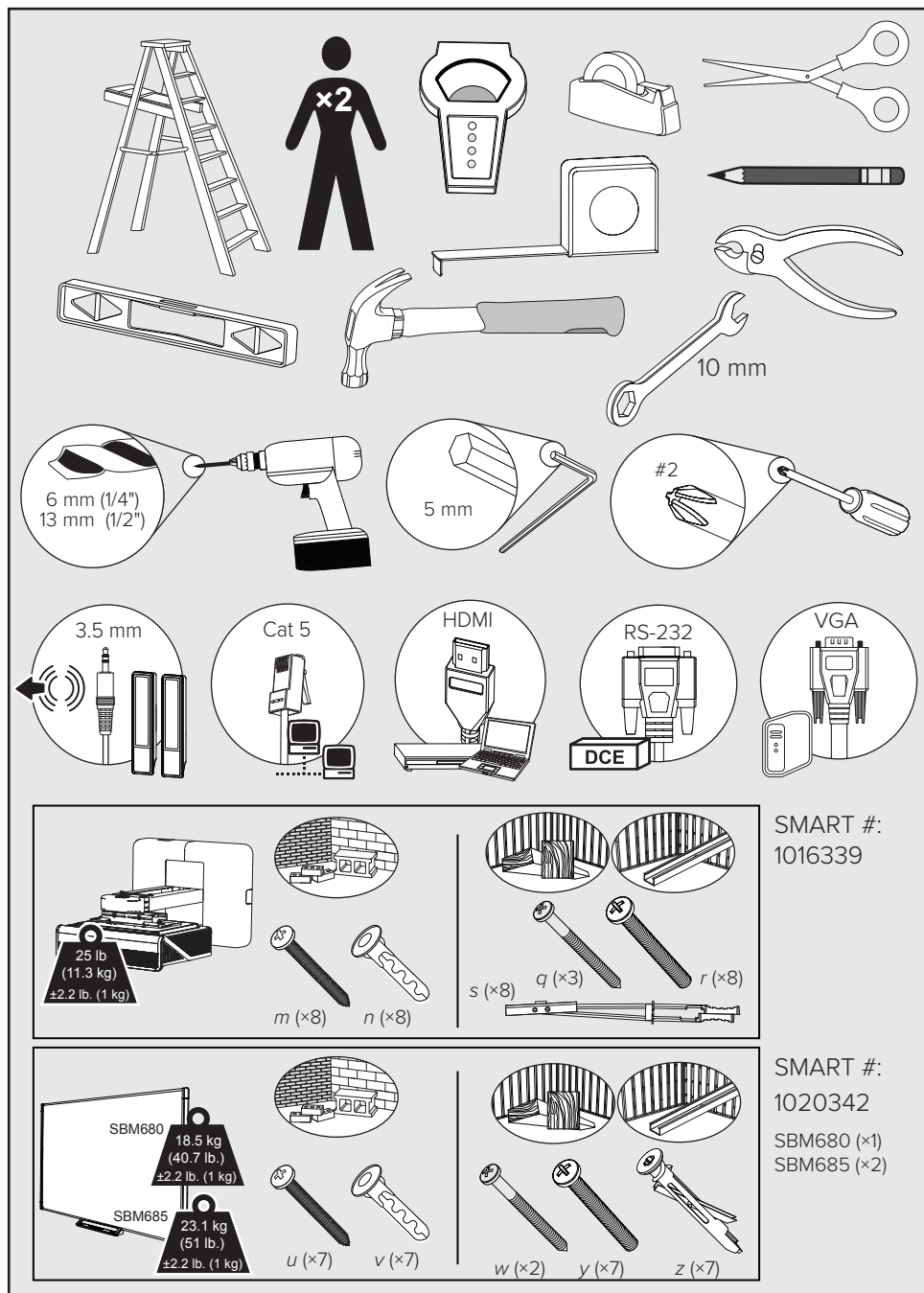



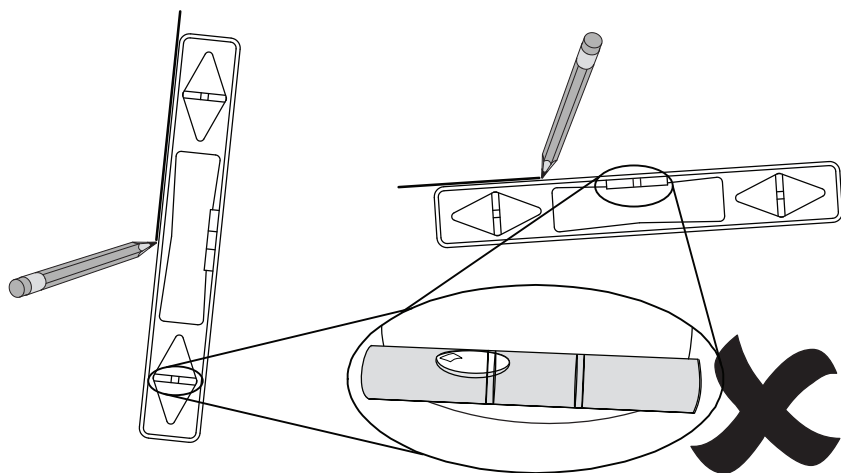
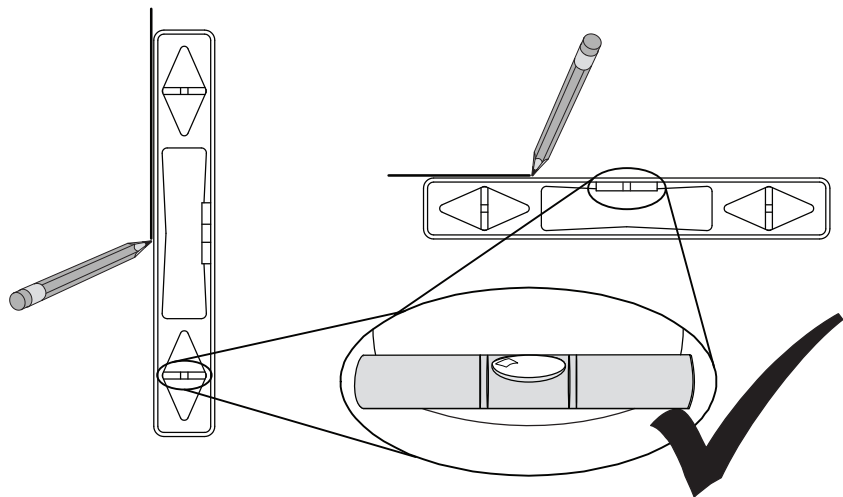

1

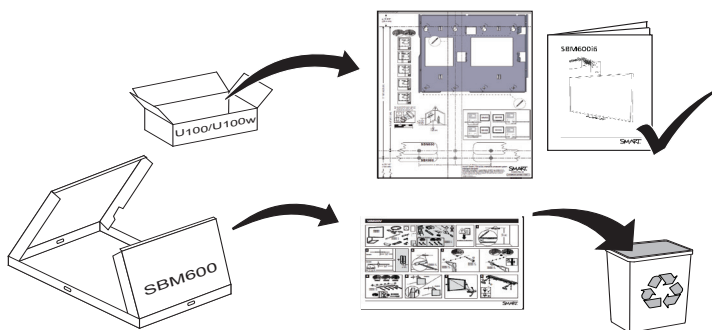

2

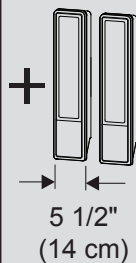
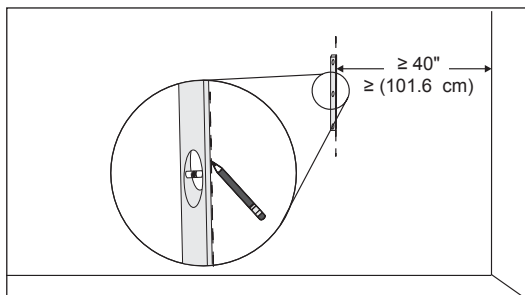
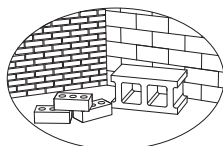
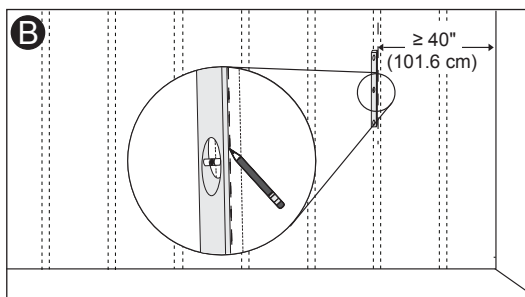
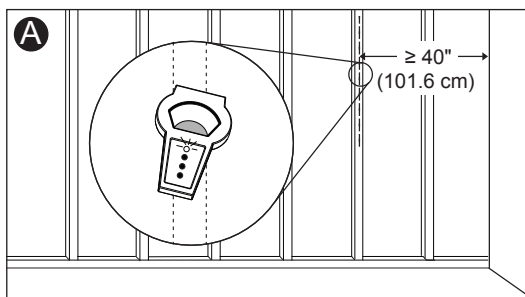
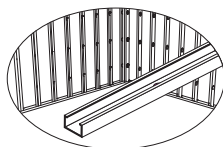
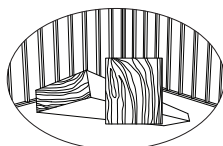

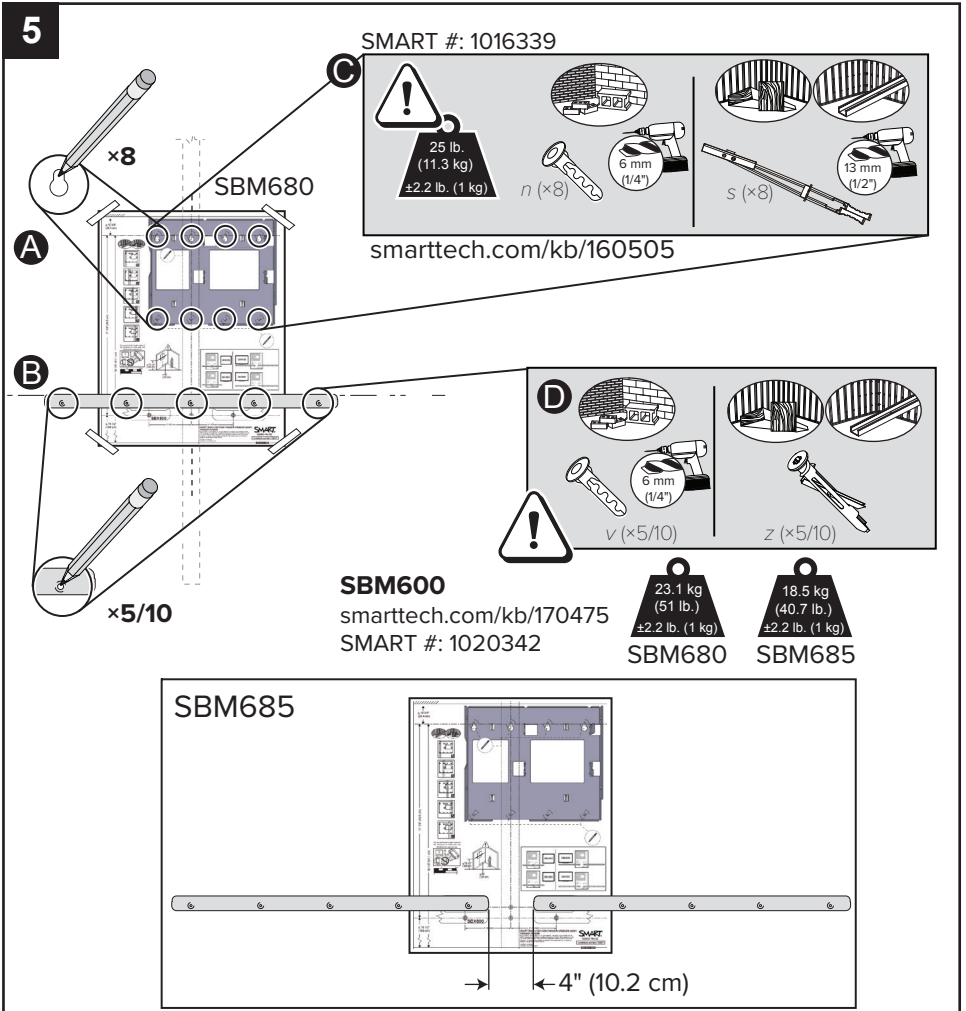
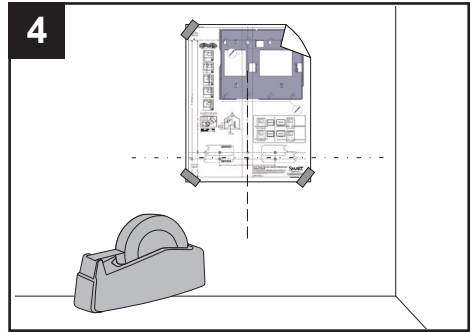
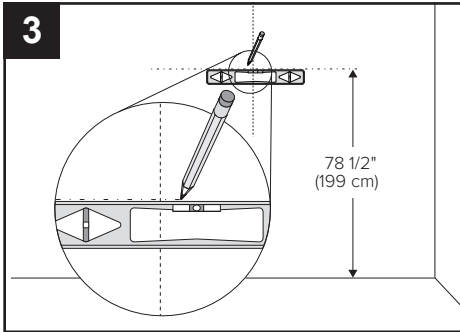

6

A

SMART #:  
1013576

[smarttech.com/kb/160505](http://smarttech.com/kb/160505)

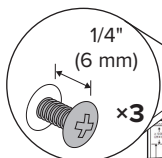

SBM680

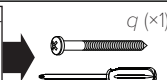
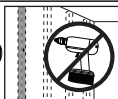
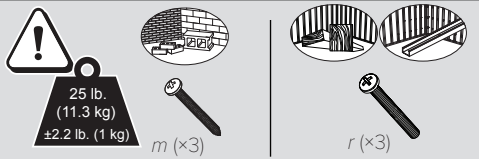

q (x1)

B

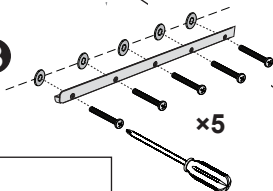

x5

SMART #:  
1020342

[smarttech.com/kb/170475](http://smarttech.com/kb/170475)

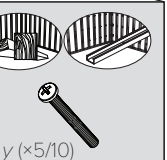
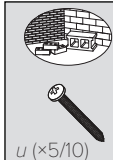

w

SBM685

x10

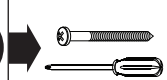
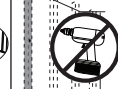

w

7

A

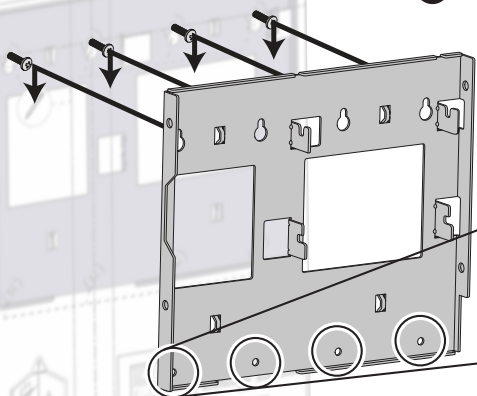

B

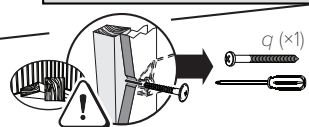
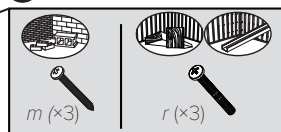

q (x1)

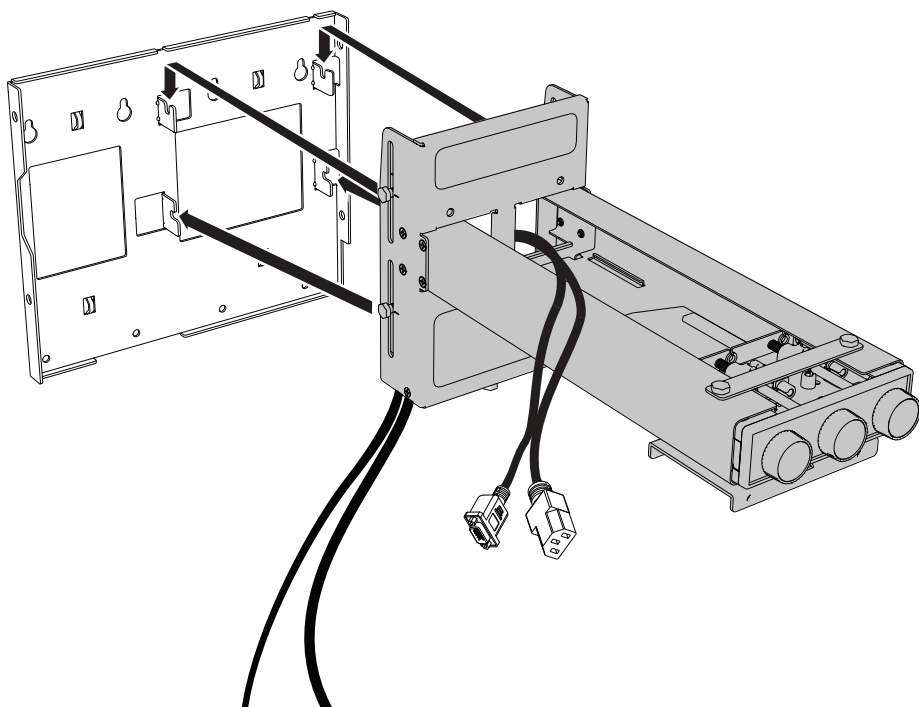
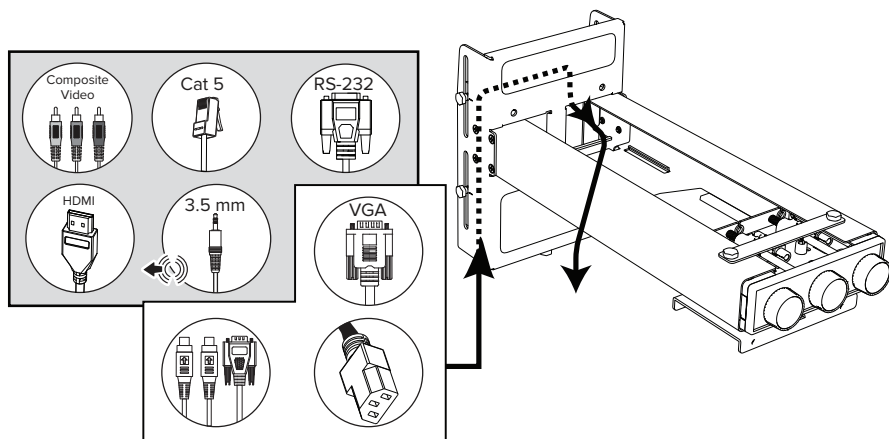

9

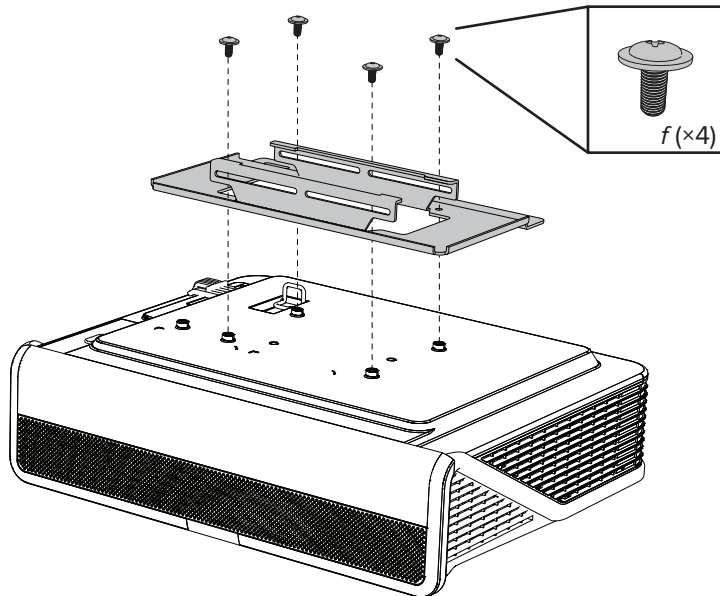

10

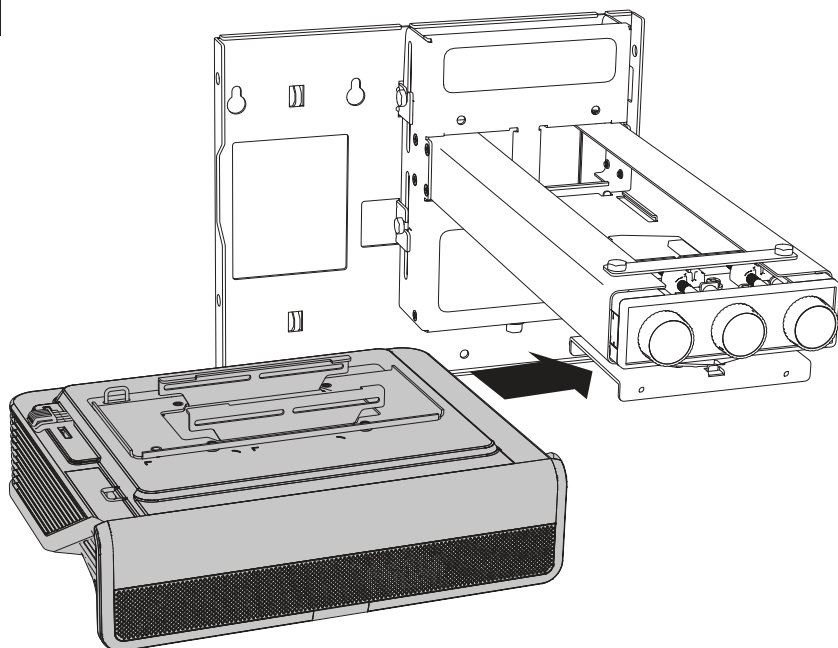

11

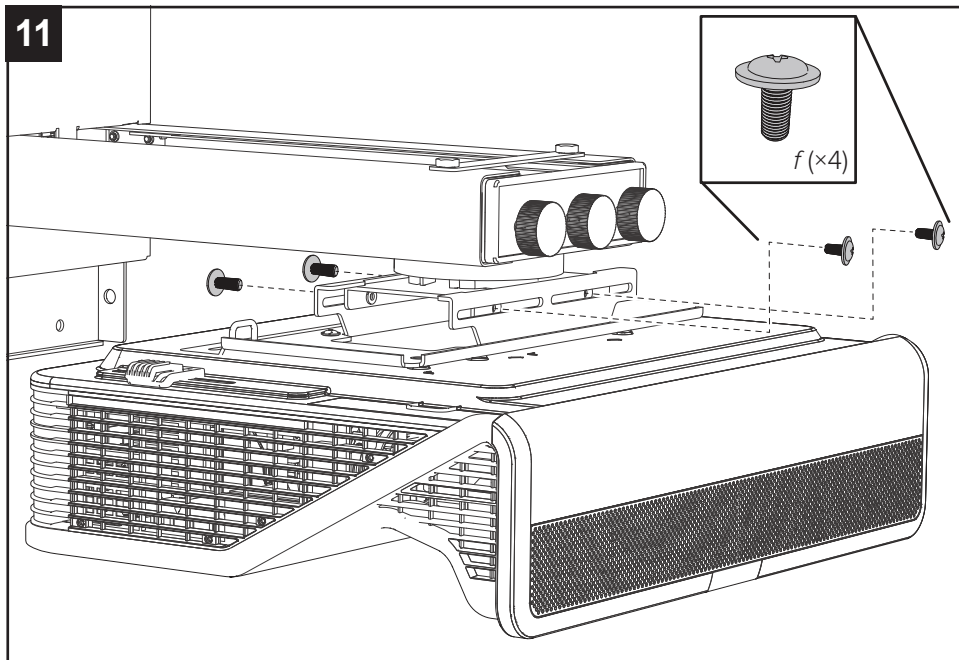

12

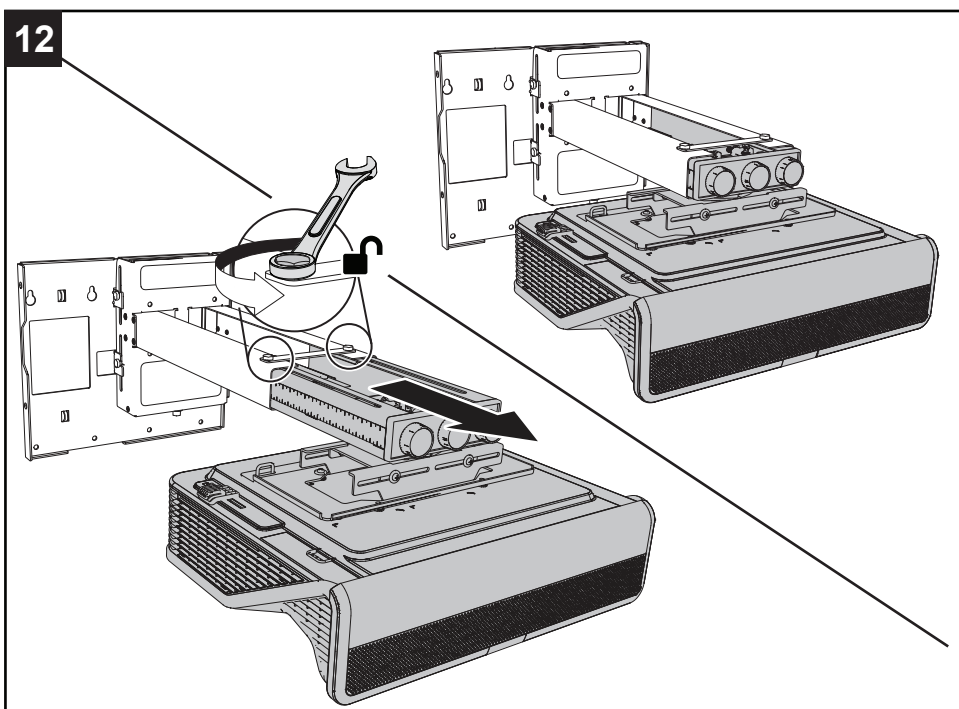

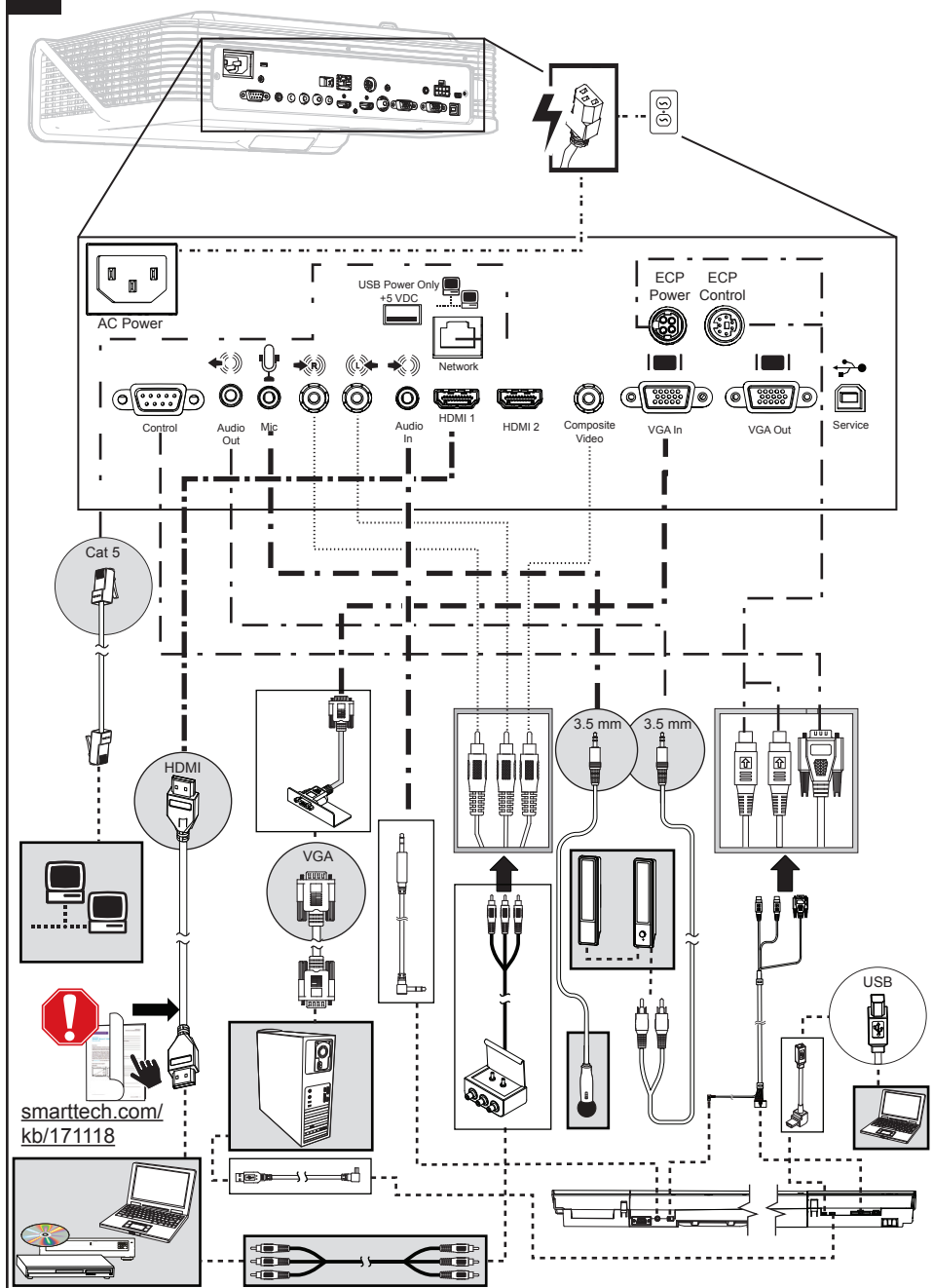





SBM680

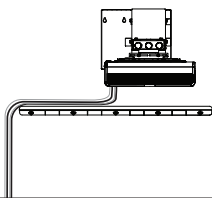

SBM685

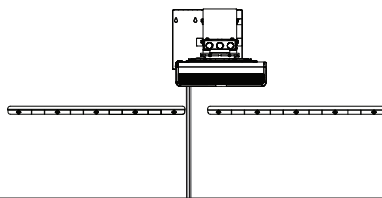

14

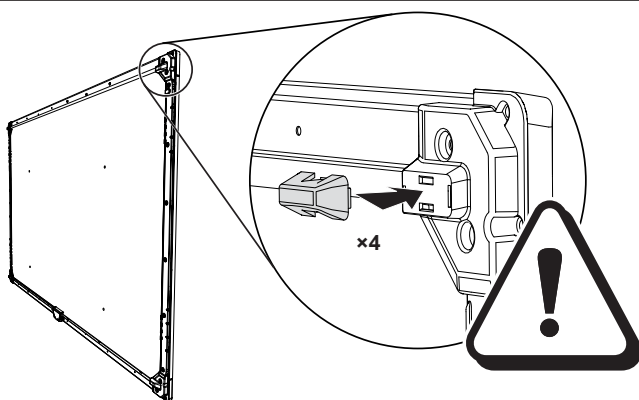

15

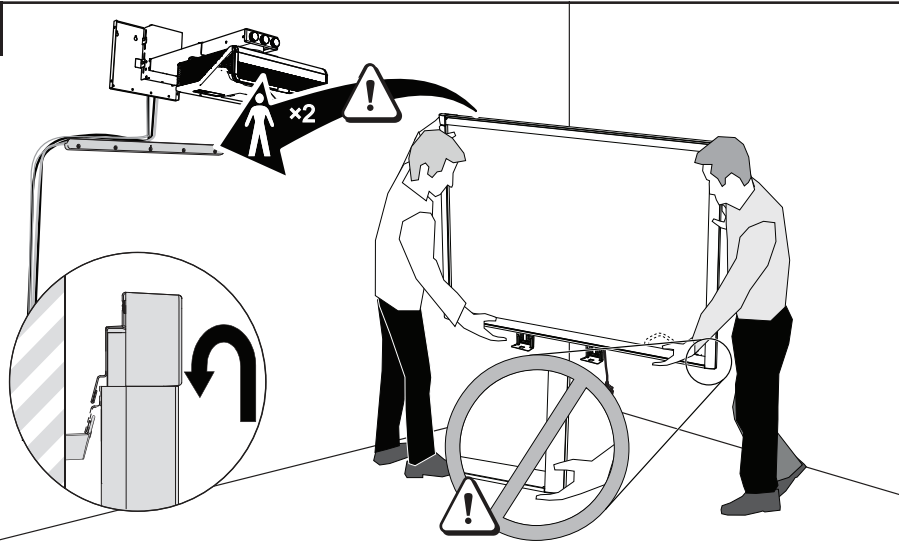

16

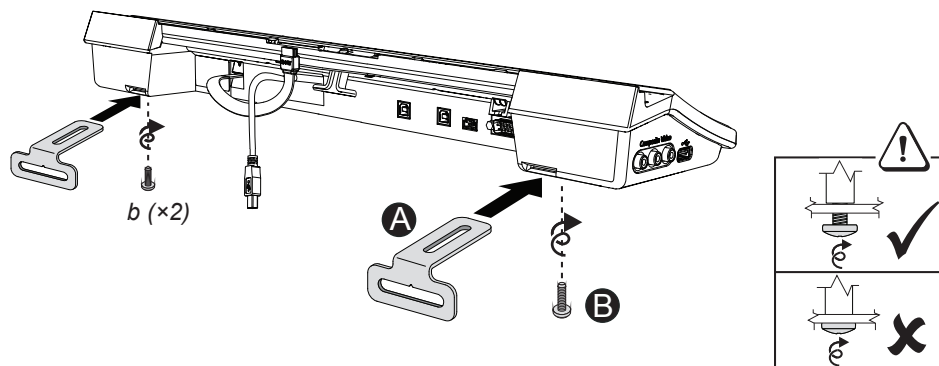

17

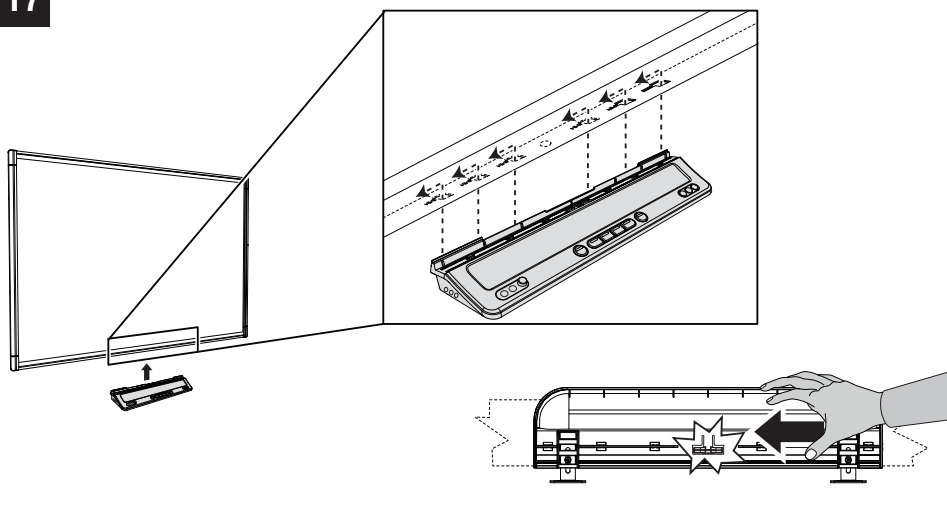

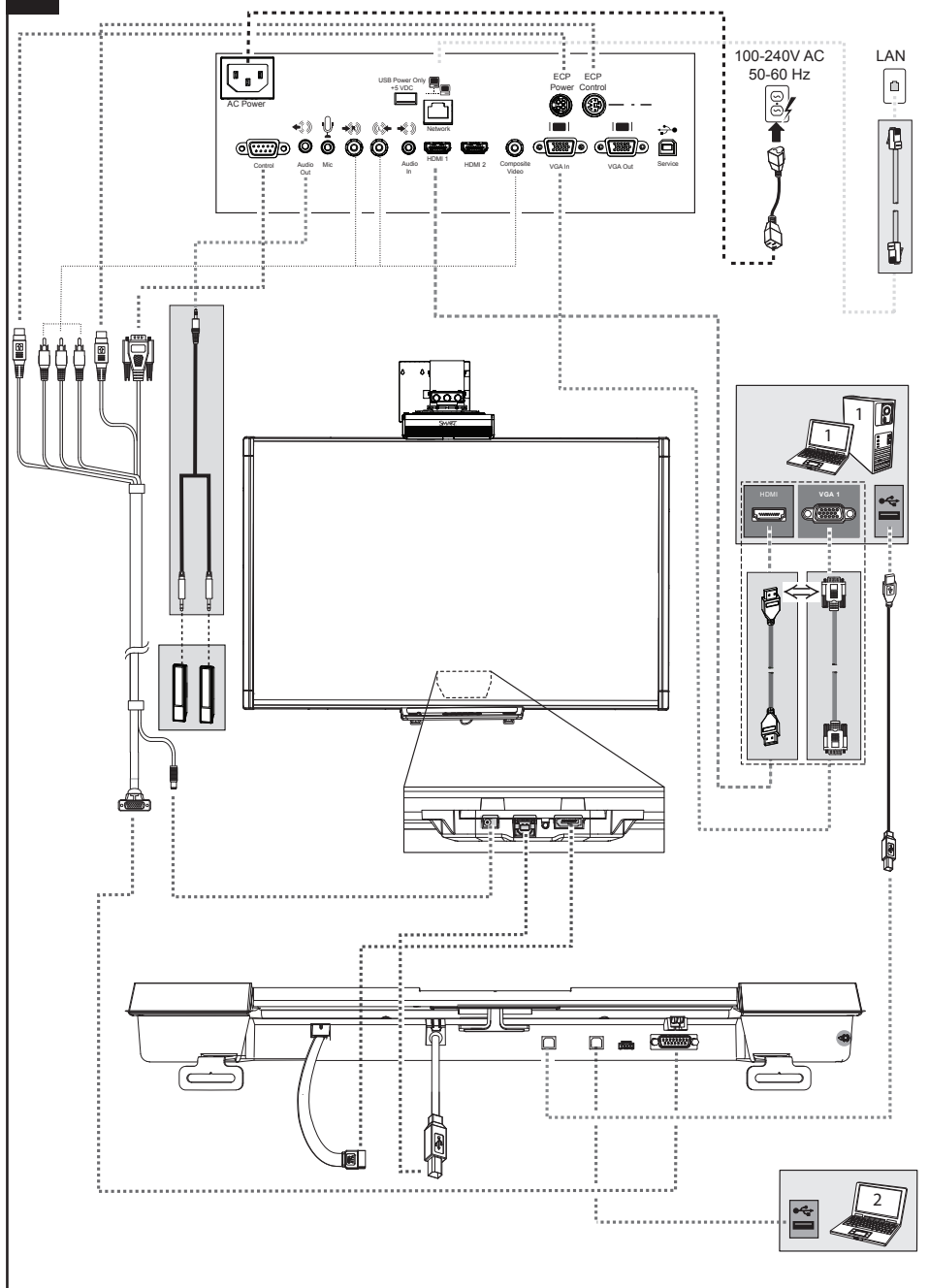

19

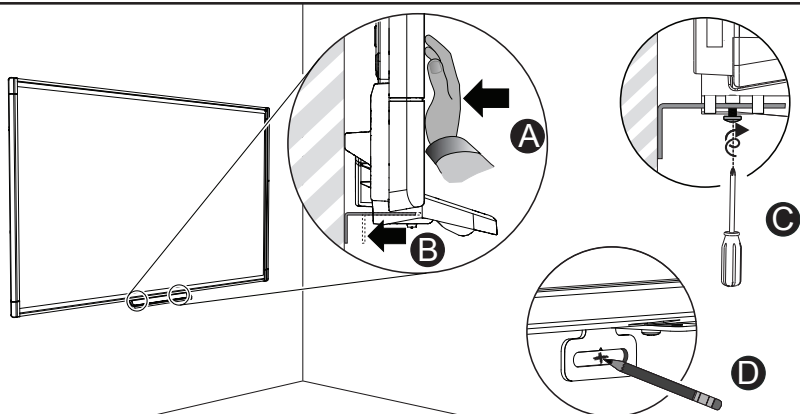

20

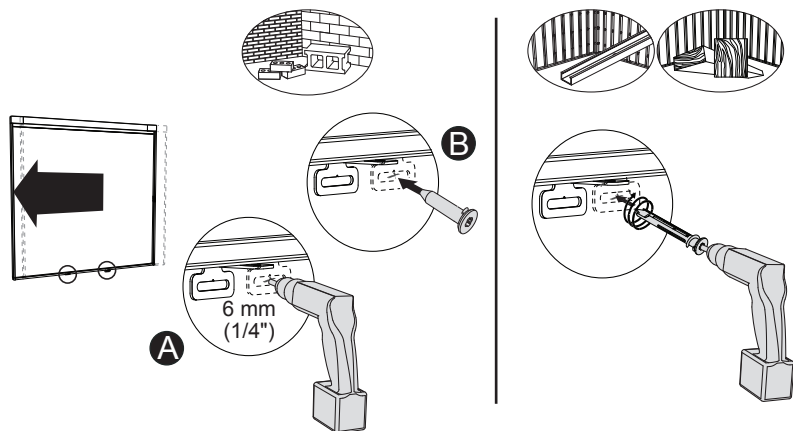

21

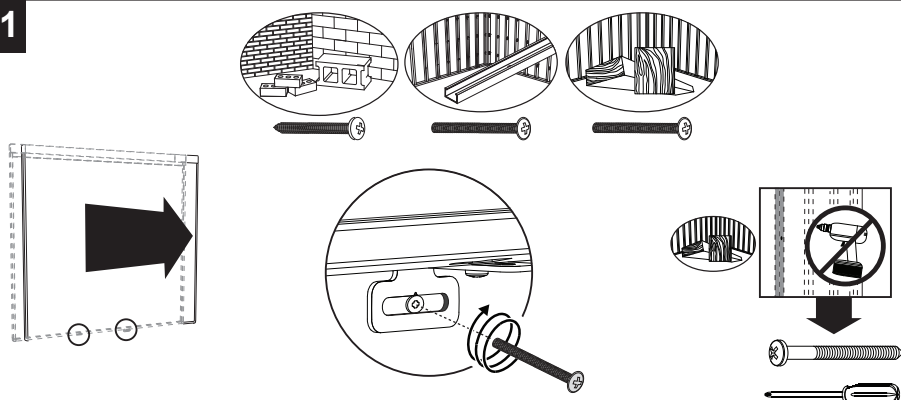

22

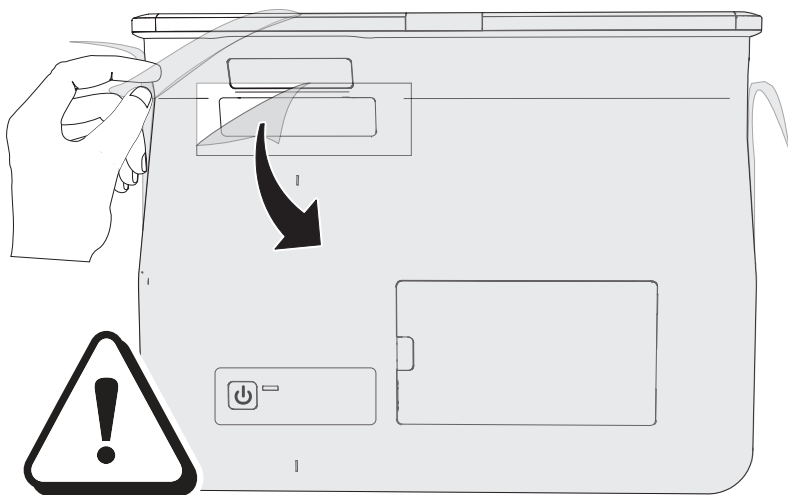

23

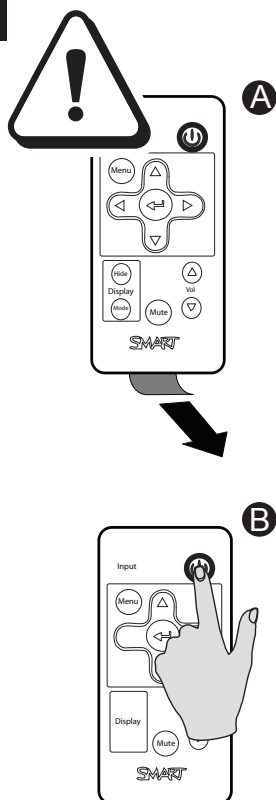

24

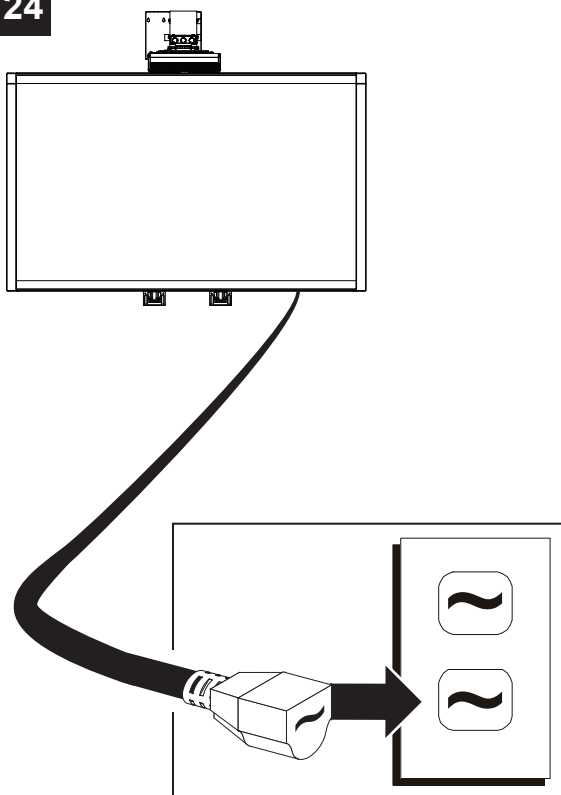

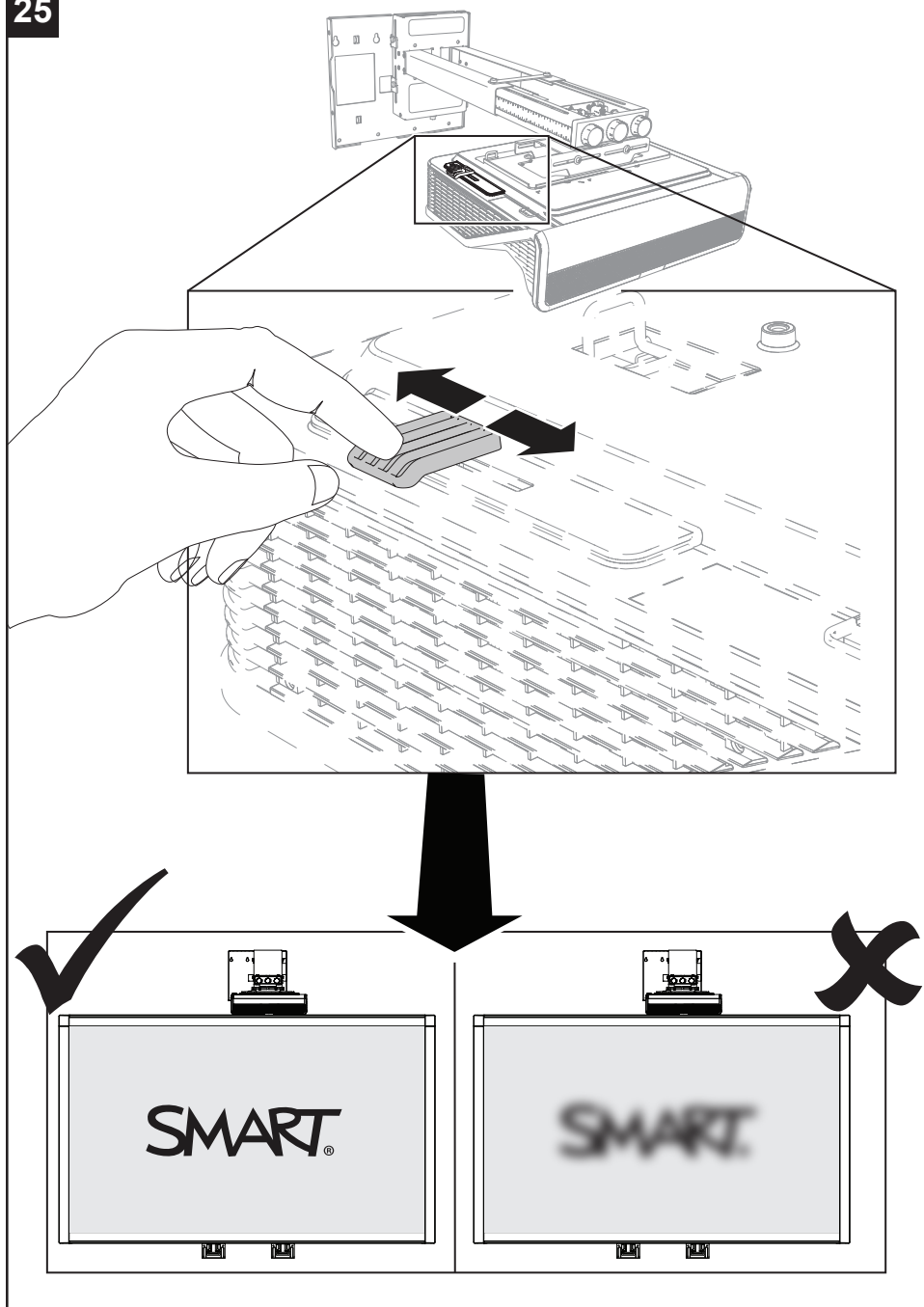

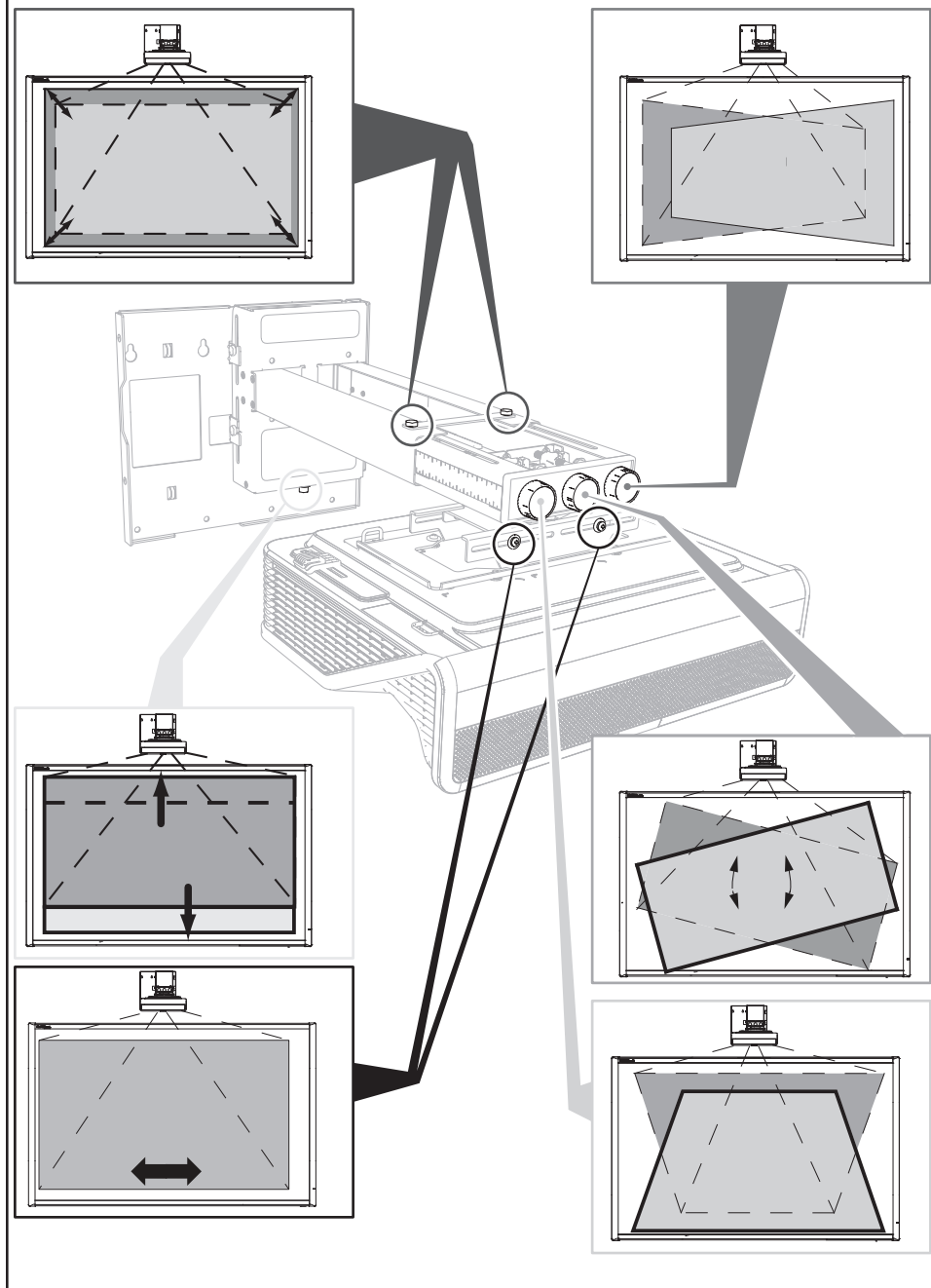

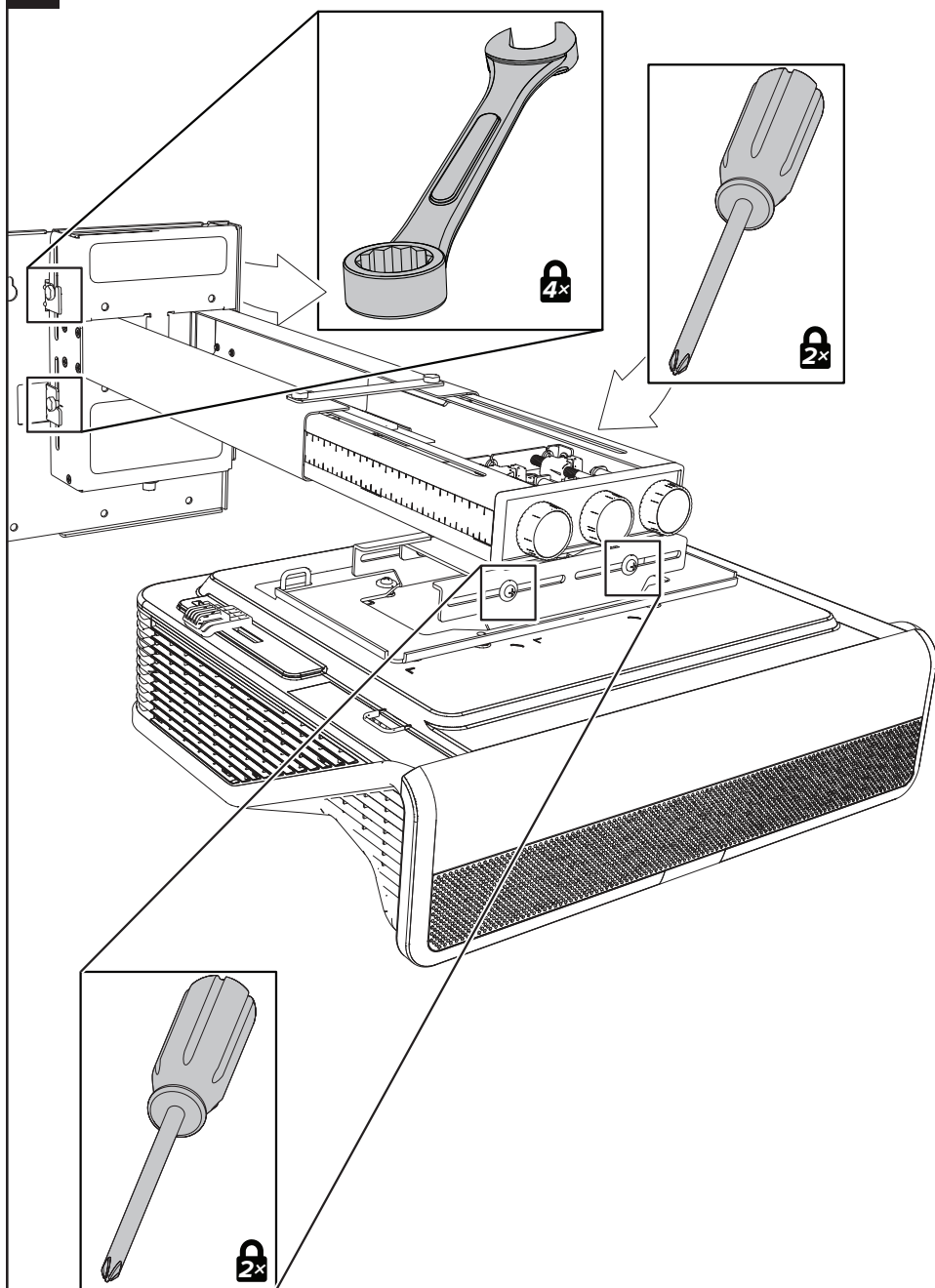



28

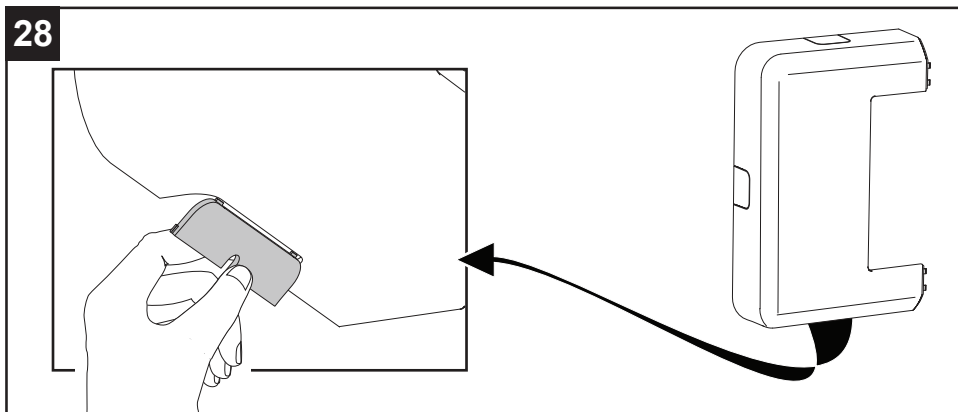

29

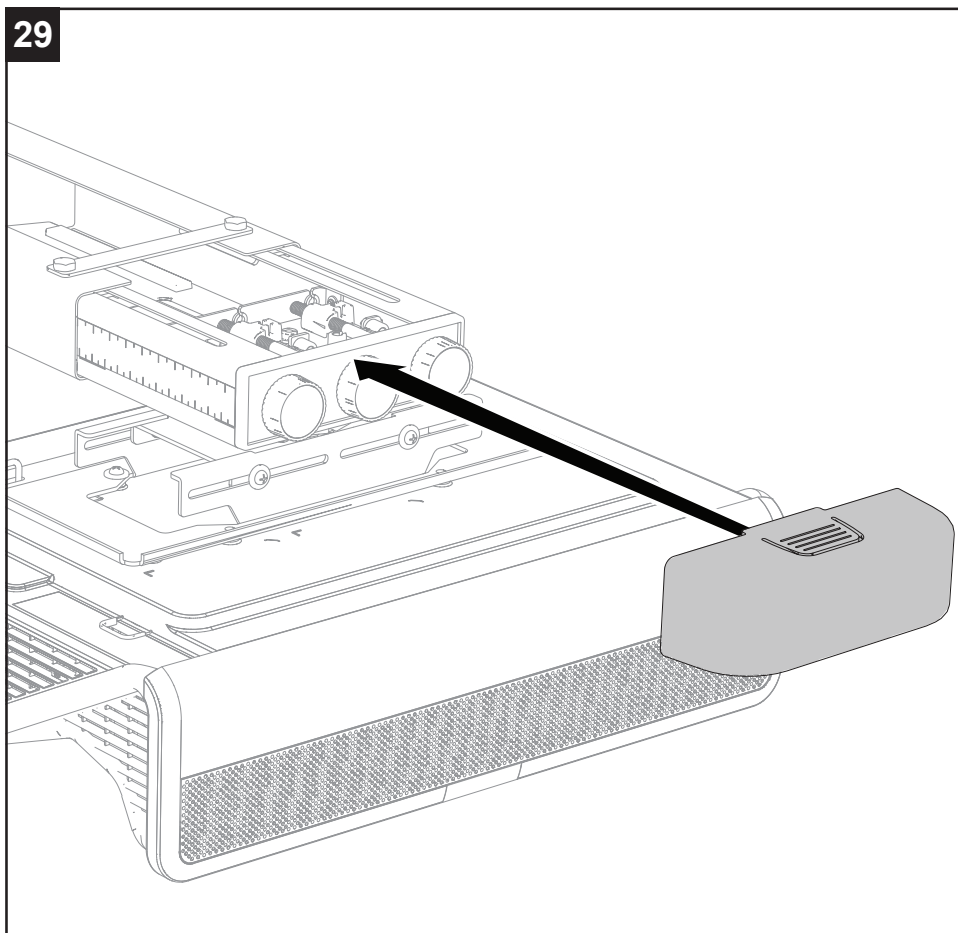

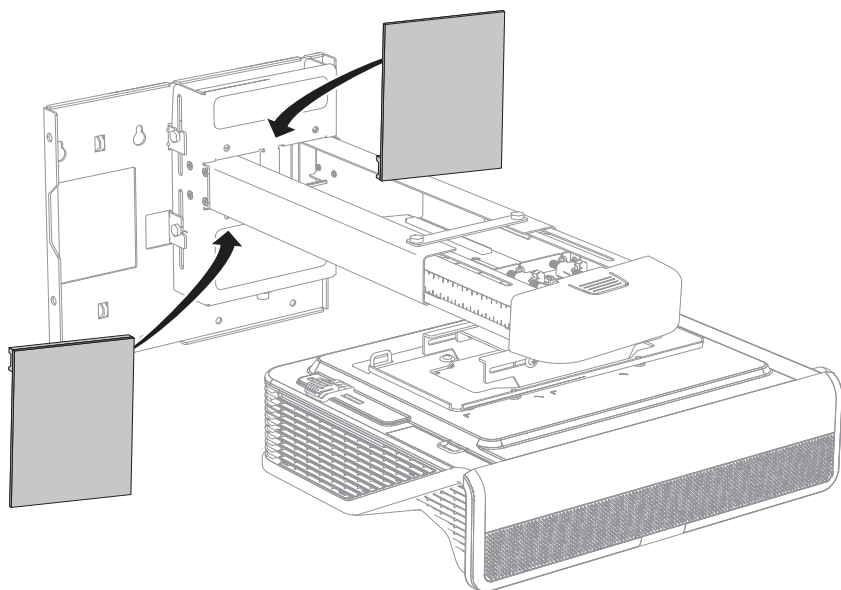
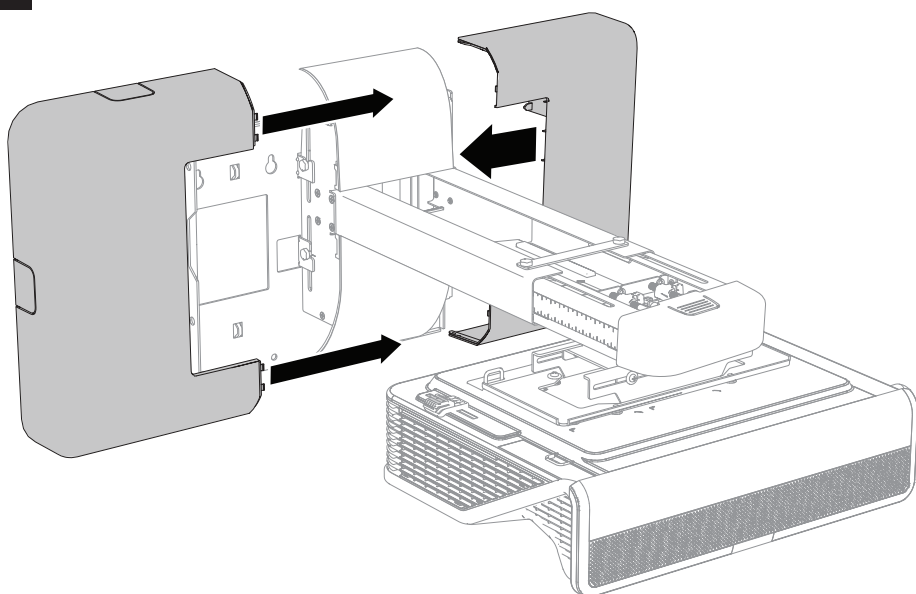
**30****31**

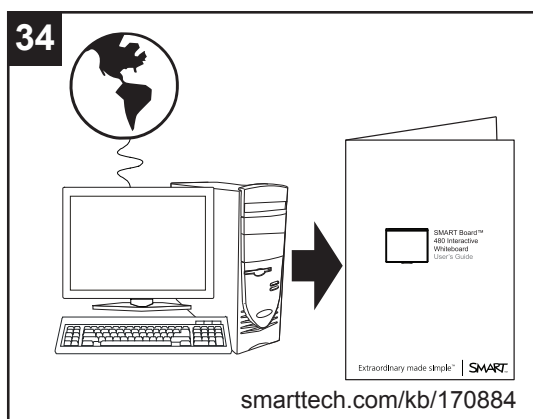
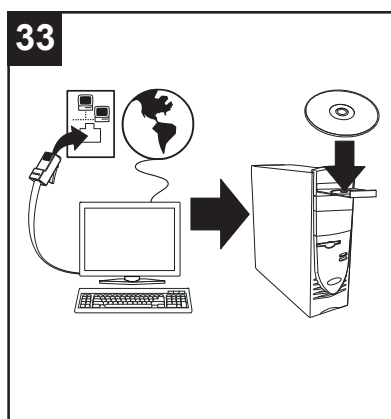
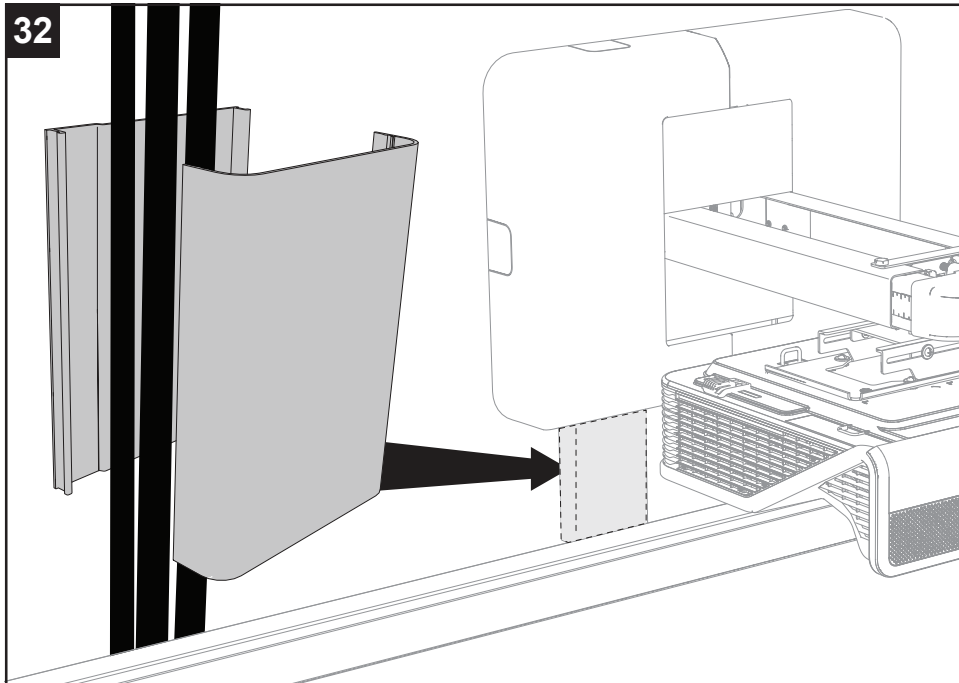

**SMART Board M680ix2**  
[smarttech.com/kb/170912](http://smarttech.com/kb/170912)

**SMART Board M685ix2**  
[smarttech.com/kb/170913](http://smarttech.com/kb/170913)

## Hardware environmental compliance

SMART Technologies supports global efforts to ensure that electronic equipment is manufactured, sold and disposed of in a safe and environmentally friendly manner.



### **Waste Electrical and Electronic Equipment and Battery regulations (WEEE and Battery Directives)**

Electrical and electronic equipment and batteries contain substances that can be harmful to the environment and to human health. The crossed-out wheeled bin symbol indicates that products should be disposed of in the appropriate recycling stream and not as regular waste.



### **Batteries**

The remote contains a lithium ion battery. Recycle or dispose of batteries properly.

### **Perchlorate material**

Battery contains perchlorate material. Special handling may apply. See [dtsc.ca.gov/hazardouswaste/perchlorate](http://dtsc.ca.gov/hazardouswaste/perchlorate).



### **Mercury**

The lamp in this product contains mercury and must be recycled of in accordance with local, state, provincial or federal laws.

See [smarttech.com/compliance](http://smarttech.com/compliance) for more information.



[smarttech.com/support](http://smarttech.com/support)  
[smarttech.com/contactsupport](http://smarttech.com/contactsupport)

© 2015-2016 SMART Technologies ULC. All rights reserved. SMART Board, smarttech, the SMART logo and all SMART taglines are trademarks or registered trademarks of SMART Technologies ULC in the U.S. and/or other countries. All third-party products and company names may be trademarks of their respective owners. Contents are subject to change without notice. This product and/or use thereof covered by one or more of the following U.S. patents. [www.smarttech.com/patents](http://www.smarttech.com/patents). Other patents pending. 09/2016.

**SMART**®

1026886 Rev 05

[smarttech.com/kb/170886](http://smarttech.com/kb/170886)